

UPPAbaby®
MESA®



From 4-35 lbs



USA

UPPAbaby, 276 Weymouth Street, Rockland, MA 02370 | uppababy.com | 1.844.823.3132

Model 1017-MSA-US

All rights reserved. © 2020 UPPAbaby. UPPAbaby and all associated logos are trademarks. All product specifications are correct at time of print. UPPAbaby reserves the right to change anything at any time without prior notice. Color representation is as close as print processes allow. Not all colors available at all retailers. **UBMAN065-V01**

❖ TABLE OF CONTENTS

Read all instructions before use of the rear-facing car seat.
Keep instruction book for future use.
(Storage pocket located on underside of base.)

BEFORE YOU BEGIN	3
CERTIFICATION	3
USE RECOMMENDATIONS	3
REGISTRATION	4
NOTICE OF EXPIRATION	4
WARNINGS + GENERAL SAFETY INSTRUCTIONS	5
REAR-FACING SEAT FEATURES	10
OVERVIEW OF BASE	10
OVERVIEW OF CARRIER	12
VEHICLE COMPATIBILITY	14
CHOOSING A VEHICLE SEATING LOCATION	14
DETERMINING BEST INSTALLATION METHOD	15
BASE INSTALLATION	15
CARRIER INSTALLATION WITHOUT BASE	15
OVERVIEW OF LATCH	16
OVERVIEW OF VEHICLE SEAT BELT SYSTEMS	17
UNSAFE VEHICLE SEAT BELT SYSTEMS + SEATING	18
BASE INSTALLATION WITH LOWER ANCHORS	19
LEVELING BASE	19
BASE INSTALLATION WITH LOWER ANCHORS	20
SAFETY CHECK	21
UNINSTALLING BASE	21
BASE INSTALLATION WITH VEHICLE SEAT BELT	22
LEVELING BASE	22
SECURING THE BASE WITH VEHICLE SEAT BELT	22
SECURING THE BASE (LAP AND SHOULDER BELT INSTALLATION)	23
SECURING THE BASE (LAP BELT ONLY INSTALLATION)	24
SAFETY CHECK	25
UNINSTALLING BASE	25

CARRIER INSTALLATION WITH VEHICLE SEAT BELT	26
LEVELING THE CARRIER	26
DETERMINING BEST INSTALLATION METHOD	26
LAP/SHOULDER BELT STANDARD ROUTING METHOD	27
INSTALLATION WITH LOCKING CLIP	28
LAP BELT ONLY ROUTING METHOD	29
SAFETY CHECK	29
AIRCRAFT INSTALLATION	30
GENERAL USE	31
HARNES BUCKLE POSITIONING	31
INFANT INSERT (RECOMMENDED 4-8 LBS)	32
SIP CARRIAGE + HARNES POSITIONING	32
SECURING YOUR CHILD	33
PINCH TEST	34
ATTACHING CARRIER TO BASE	35
RELEASING CARRIER FROM BASE	35
HIDE-AWAY CANOPY	36
CARRY HANDLE	36
IMPORTANT CHECKS	37
STROLLER COMPATIBILITY	38
FITTING CARRIER TO STROLLER FRAME	38
RELEASING CARRIER FROM STROLLER FRAME	38
FITTING ADAPTERS TO VISTA 2014 AND EARLIER FRAME	39
FITTING CARRIER TO VISTA 2014 AND EARLIER FRAME ADAPTERS	40
RELEASING CARRIER FROM VISTA 2014 AND EARLIER FRAME ADAPTERS	40
CARE + MAINTENANCE	41
SIP PADDING REMOVAL	41
SEAT PADDING REMOVAL	42
SEAT PADDING INSTALLATION	44
SIP PADDING INSTALLATION	46
CLEANING	47
LIMITED WARRANTY	48



This child restraint system conforms to all applicable Federal Motor Vehicle Safety Standards (FMVSS).



This child restraint is certified for aircraft use. UPPAbaby and the Federal Aviation Administration (FAA) strongly urge you to secure your child in a child restraint system (CRS) or device for the duration of your flight.

This product is designed and manufactured to comply with ASTM 2050 Standard Consumer Safety Specification for Hand Held Infant Carriers, and is JPMA certified.

USE RECOMMENDATIONS

Children should remain rear-facing for as long as possible.

UPPAbaby advises that all infants and toddlers should ride in a rear-facing car safety seat (CSS) as long as possible, until they reach the highest weight or height allowed by their CSS's manufacturer. Most convertible seats have limits that will permit children to ride rear-facing for 2 years or more. This child restraint is for use by children who meet BOTH requirements below:

WEIGHT REQUIREMENTS: 4-35 lbs (1.8-15.9 kg)

Includes Infant Insert recommended for use with infants weighing 4-8 lbs (1.8-3.6 kg)

HEIGHT REQUIREMENTS: 32 in (81.3 cm) or less



The top of the child's head should not be less than 1 in from the top of the headrest when in its highest position.

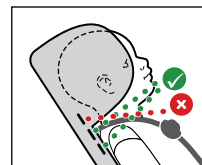

Harness should be at the shoulders or slightly below.



Retainer clip must be at armpit level **1** and harness straps should be snug **2**.

REGISTRATION



Child restraints could be recalled for safety reasons. You must register this restraint to be reached in a recall. Send your name, address, e-mail address if available, and the restraint's model number and manufacturing date to UPPAbaby, Product Registration, 276 Weymouth Street, Rockland, MA 02370-9912 or call 844-823-3132 or register online at <https://uppababy.com/register/carseat>. For recall information, call the U.S. Government's Vehicle Safety Hotline at 1-888-327-4236 (TTY: 1-800-424-9153), or go to <https://www.NHTSA.gov>.

TAKE A MOMENT TO FILL OUT THE FOLLOWING INFORMATION:

Information can be found on the manufacture labels or engraved on the underside of the carrier.

Serial Number: _____

Date of Purchase: _____

NOTICE OF EXPIRATION

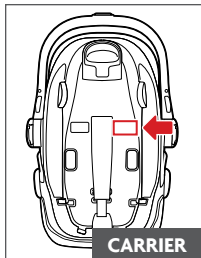

CARRIER

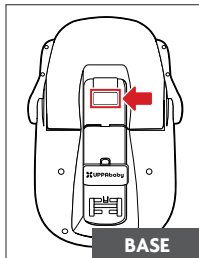

BASE

Discontinue use of this child restraint after 7 years from the date of manufacture or after a crash. Refer to labels on bottom of Carrier and Base.

UPPAbaby reserves the right to make design changes and improvements to any of our products as part of our commitment to innovation.

WARNINGS + GENERAL SAFETY INFORMATION

! WARNING

DEATH OR SERIOUS INJURY CAN OCCUR

According to accident statistics, children are safer when properly restrained in the rear seating positions than in the front seating positions.

Child restraint systems should be securely belted to the vehicle, even when they are not occupied, since in a crash an unsecured child restraint system may injure other occupants.

Use only in rear-facing position when using it in the vehicle.



NEVER place this child restraint on a front seat with an airbag. **DEATH OR SERIOUS INJURY** can occur.

An airbag can strike a rear-facing infant restraint with enough force to crack the shell and seriously injure or kill an infant. The back seat is the safest place for children 12 and under. Refer to the vehicle owner's instruction book before installing this child restraint in a seating position with side airbags.

WARNINGS + GENERAL SAFETY INFORMATION

Snugly adjust the belts provided with this child restraint around your child. A snug strap should not allow any slack. It lies in a relatively straight line without sagging. It does not press on the child's flesh or push the child's body into an unnatural position.

SUFFOCATION HAZARD: Infant carrier can roll over on soft surfaces and suffocate child. **NEVER** place carrier on beds, sofas, or other soft surfaces.

 **WARNING**

Children have **STRANGLERD** in loose or partially buckled harness straps. Fully restrain the child even when carrier is used outside the vehicle.

- **NEVER** leave child in carrier when straps are loose or undone.
- **NEVER** place carrier near window where cords from blinds or drapes can strangle a child.
- **NEVER** hang strings on or over the carrier or attach to handle.

WARNINGS + GENERAL SAFETY INFORMATION

- **NEVER** place items with a string around a child's neck, such as hood strings, pacifier cords, etc.
- FALL HAZARD:** Child's movement can slide carrier.
- **NEVER** place carrier on counter tops, tables, or any other elevated surfaces. **DO NOT** use on shopping carts.

 **WARNING**

FALL HAZARD: The carrier can fall from the shopping cart. Do not use on shopping cart.

SAFETY WARNINGS:

Failure to follow these instructions could result in serious injury to your child or other vehicle occupants.

- **NEVER** leave child unattended.
- **DO NOT** use the carrier or base if it is damaged or broken, expired (over 7 years from date of manufacture), missing instructions, missing parts, or if the straps are cut, frayed, or damaged in any way.
- **DO NOT** use this child restraint system if it has been in a vehicle accident.

WARNINGS + GENERAL SAFETY INFORMATION

- **DO NOT** use clothing or blankets that interfere with fastening or tightening the harness. **INSTEAD** place a blanket over the child after being properly secured in the harness.
- **DO NOT** use this child restraint if the top of the child's head is less than 1 in from the top of the headrest when in its highest position.
- **DO NOT** use this child restraint in a vehicle seating position where it cannot be tightly secured.
- **DO NOT** install in rear-facing or side-facing vehicle seats.
- **DO NOT** modify this restraint except as instructed in this instruction book. Minor modifications can change the way a child restraint performs in a crash.
- **DO NOT** carry by the canopy.
- **DO NOT** leave loose objects, e.g. cups, toys, bags, umbrellas, etc., in the vehicle because they can become deadly projectiles in a crash.
- **DO NOT** take child out of the child restraint while the vehicle is moving.
- **DO NOT** allow children to play with this child restraint. It is not a toy.

WARNINGS + GENERAL SAFETY INFORMATION

- **DO NOT** use any accessories, pads or products supplied by other manufacturers with this child restraint, unless approved and tested by UPPAbaby. Items not tested with this restraint could injure your child.
- **DO NOT** place carrier on top of shopping cart. Carrier will not be secure and could fall causing injury to child.
- **DO NOT** remove or cover up any of the warning or product labels on this child restraint. All labels include information required by law.
- **DO NOT** lubricate buckles and fasteners.
- **ALWAYS** keep child properly harnessed when child is in carrier.
- **ALWAYS** check all surfaces of restraint before securing your child. In warm weather, child restraints can become very hot. Park the car in the shade or where sun does not directly hit the child restraint. Cover the child restraint with a sheet or blanket when not in use.
- **ALWAYS** properly store lower anchor connectors when not in use.

OVERVIEW OF BASE

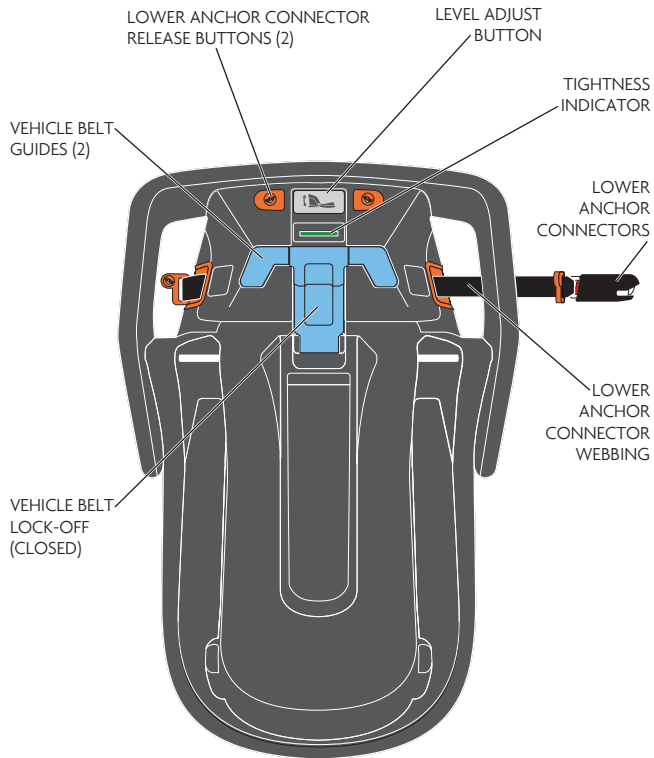

OVERVIEW OF BASE

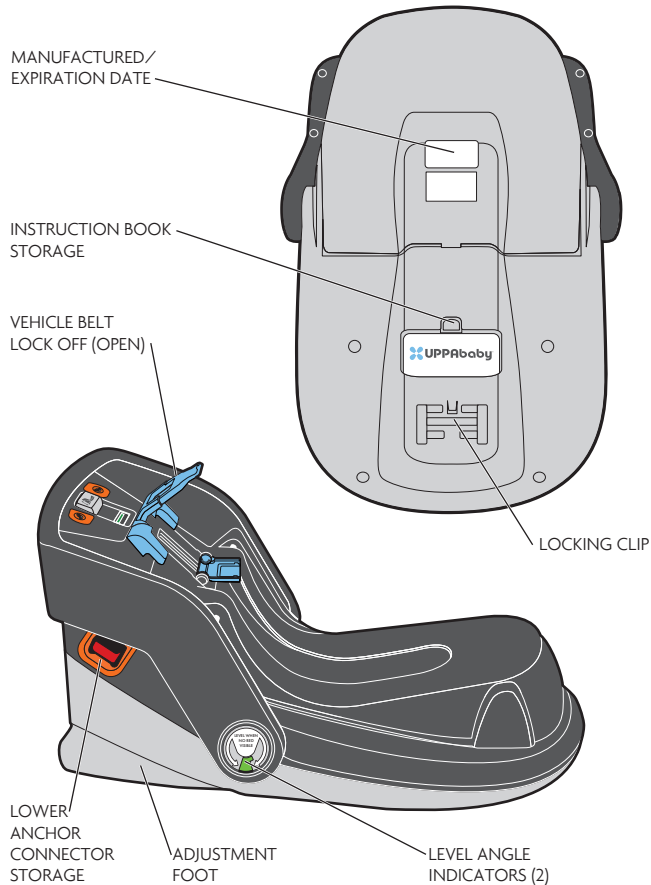

OVERVIEW OF CARRIER

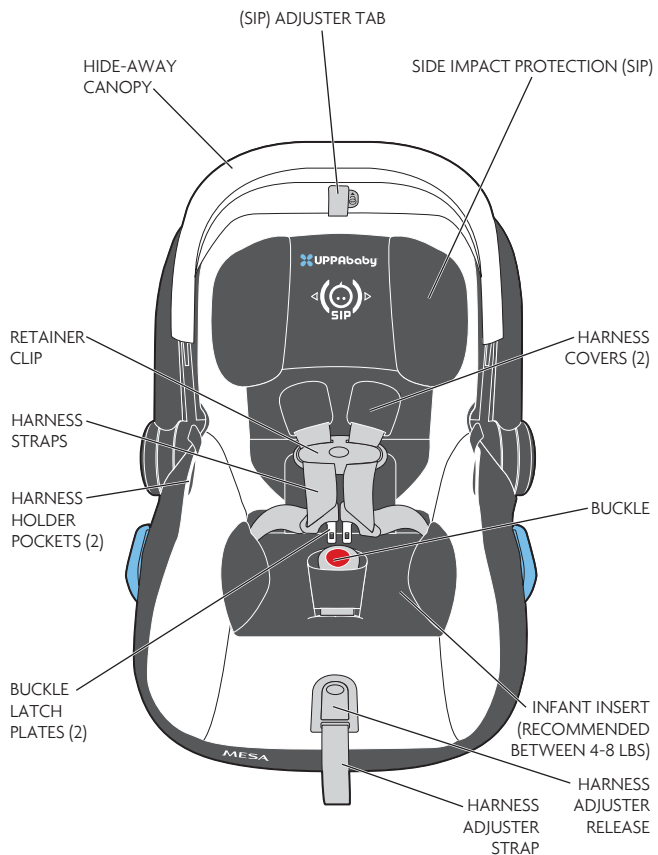

OVERVIEW OF CARRIER



CHOOSING A VEHICLE SEATING LOCATION

PLEASE READ THE FOLLOWING INFORMATION BEFORE INSTALLING THIS CHILD RESTRAINT!



Always park on a level surface when installing a child restraint.

The safest seating position is one that works best for your specific car seat, family and vehicle. When determining whether the MESA Rear-Facing Car Seat can be used with lower anchors in the rear center seating position, it is critical that you refer to your vehicle owner's instruction book. If the MESA does not install best in the rear center seating location, it is recommended to move to one of the outboard seating positions.

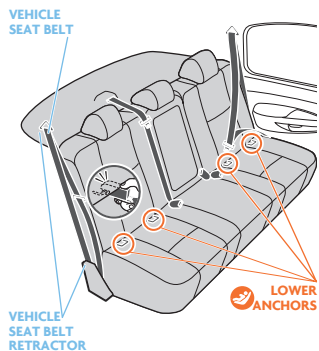

Before installing this child restraint you must determine the method of installation and the best vehicle seating position for that method. This child restraint can be installed either using **LATCH** or the **Vehicle Seat Belt**.

DETERMINING BEST INSTALLATION METHOD

At this point take out your VEHICLE OWNER'S INSTRUCTION BOOK. You will need this to look up different features in your vehicle that might affect the installation.

⚠ WARNING!
NEVER place a rear-facing only child restraint in front of an active airbag.

BASE INSTALLATION

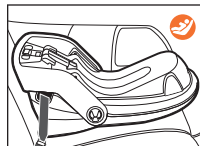

Lower Anchor Installation (pg. 19)

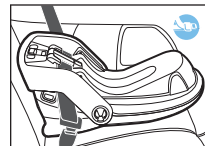

Lap/Shoulder Belt Installation (pg. 22)

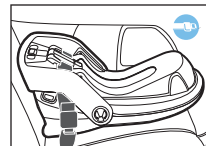

Lap Belt Only Installation (pg. 22)

CARRIER INSTALLATION WITHOUT BASE



Lap/Shoulder Belt Standard Routing Method (pg. 26)



Lap Belt Only Routing Method (pg. 26)

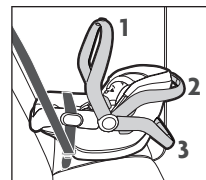

NOTE: The carry handle must be locked in any (3) positions when in use (p. 29).



OVERVIEW OF LATCH

Most vehicles manufactured after September 1, 2002 are equipped with **LATCH** (Lower Anchors and Tethers for Children). Check your vehicle owner's instruction book to determine lower anchor compatible seating positions.

NOTE: No tether is required with this rear-facing carrier. Only lower anchors are used.

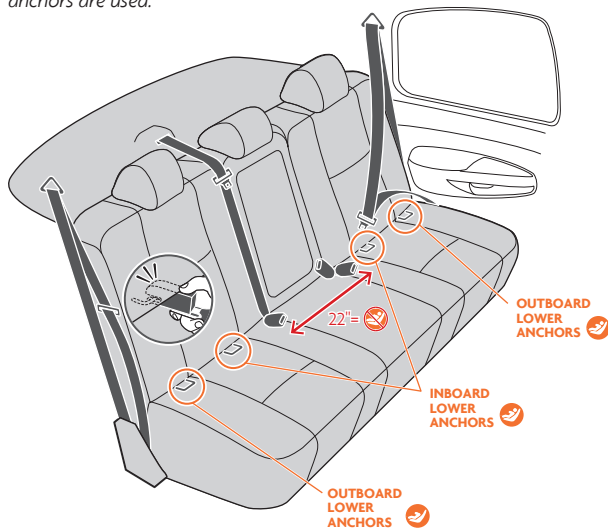

NOTE: In order to use the rear center seating position with lower anchor, the distance between the lower anchors may be up to 22 in and the seating position must be approved by the vehicle manufacturer. If spacing between the lower anchors is greater than 22 in or if the seating position is not approved by the vehicle manufacturer then use the vehicle seat belt for installation.



OVERVIEW OF VEHICLE SEAT BELT SYSTEMS

If you do not use lower anchor to properly secure the child restraint you must use the **Vehicle Seat Belt System**. Seat belt systems vary by make, model, and year of your vehicle. There are some vehicle belts that will NOT work with this child restraint or that require additional steps.

CHECK YOUR VEHICLE OWNER'S INSTRUCTION BOOK for information regarding your vehicle seat belt system(s).

This child restraint is compatible with most vehicle seat belt systems.

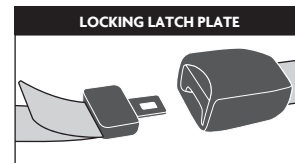
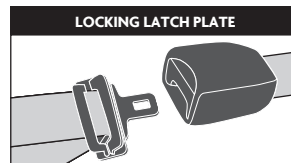
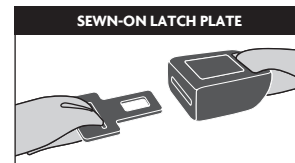
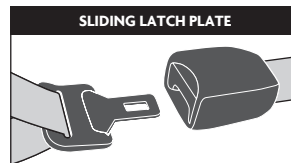
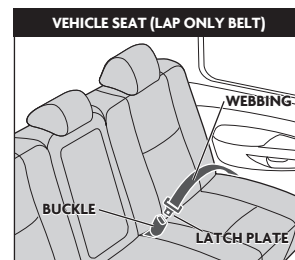
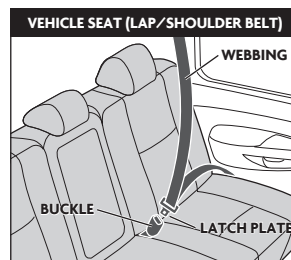



⚠️ WARNING

DEATH OR SERIOUS INJURY CAN OCCUR

CHECK YOUR VEHICLE INSTRUCTION BOOK
for information regarding your vehicle seat belt system(s).
Not all vehicle seat belts work with this child restraint.

DO NOT use this child restraint with the following seat belt systems:

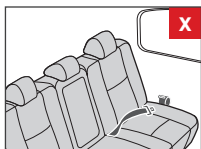

Lap belts with emergency locking retractor

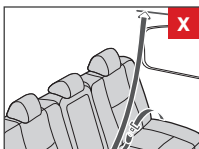

Motorized (automatic)

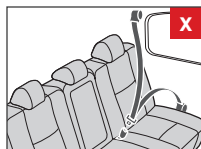

Lap/Shoulder with two retractors

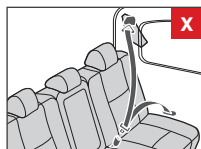

Door mounted

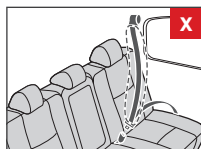

Inflatable

DO NOT use this child restraint with the following vehicle seats:

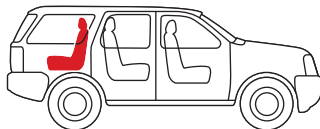

Vehicle seats that face rear of the vehicle



Vehicle seats that face side of the vehicle

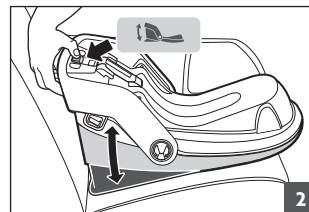
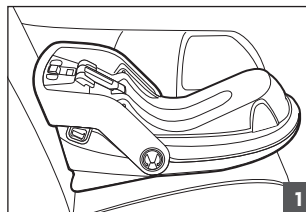

STEP 1: Place the base on the vehicle seat with the adjustment foot toward the vehicle seat back.

STEP 2: Press the level adjust button on the top of the base to extend the foot and change the recline angle. Check the angle indicators on either side of the base. The base is level when only the green marker is visible between the two arrows. No red should be visible.

NOTE: Vehicle must be parked on a level surface to properly level the base.



NOTE: If proper angle cannot be achieved with adjustable foot, pool noodles or a rolled towel may be used. Foot must be in fully extended position.

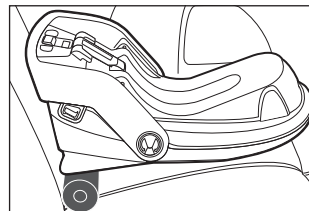



BASE INSTALLATION WITH LOWER ANCHORS

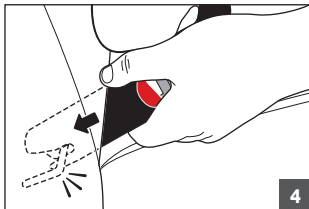
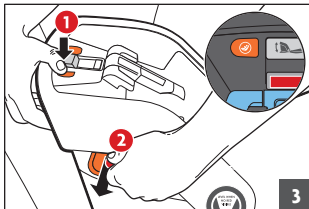

STEP 3: Locate the lower anchor connectors on either side of the base and remove by pushing the corresponding orange button on the top of the base **1** while pulling the connector out of the lower anchor storage pocket **2**.

STEP 4: Attach the lower anchor connectors to the vehicle lower anchors located in the vehicle seat bight (crease of seat).

NOTE: Check lower anchor connectors are in the upright position.

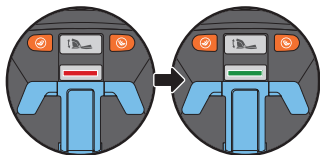
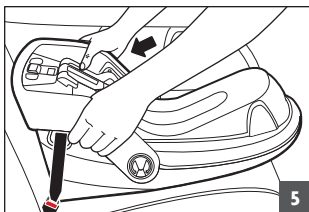

STEP 5: Apply pressure firmly into the base allowing all the excess lower anchor connector webbing to retract and tighten.

NOTE: Push into the seat bight (crease of seat). Installation is complete when tightness indicator turns from red to green and stays green when downward push is discontinued.



SAFETY CHECK

- Base doesn't move more than 1 in side to side at the belt path **A**.
- Ensure tightness indicator is green after each use. If it is not, apply pressure by pushing base into seat bight (crease of seat) to tighten **B**.
- Lower anchor belts are secure and untwisted
- Recline angle is correct. Base is level when only green is visible between the two arrows on the level indicator. No red should be visible **C**.

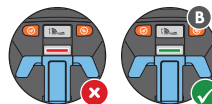
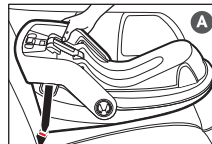

UNINSTALLING BASE

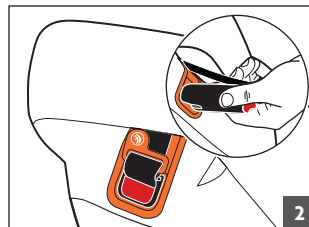
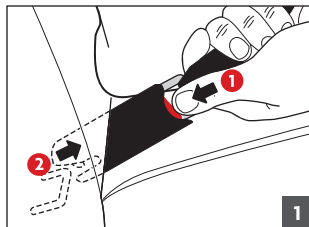

STEP 1: Press the red button on the lower anchor connector **1** while pulling the connector off the vehicle anchor **2**.

STEP 2: Store lower anchor connectors in designated housing found on each side of the base.



LEVELING BASE

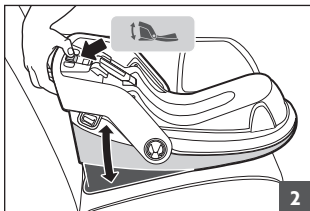
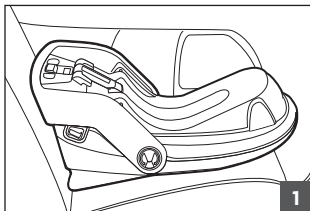

STEP 1: Place the base on the vehicle seat with the adjustment foot toward the vehicle seat back.

STEP 2: Press the level adjust button on the top of the base to extend the foot and change the recline angle. Check the angle indicators on either side of the base. The base is level when only the green marker is visible between the two arrows. No red should be visible.



NOTE: If proper angle cannot be achieved with adjustable foot, pool noodles or a rolled towel may be used. Foot must be in fully extended position.

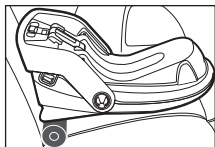

SECURING THE BASE WITH VEHICLE SEAT BELT

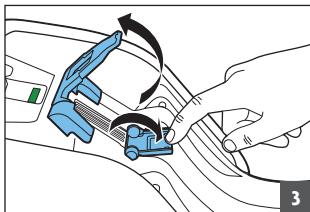

STEP 3: Open lock-off.

PROCEED TO:

Securing the Base (Lap and Shoulder Belt Installation)—pg. 23, steps 4A-6A

or

Securing the Base (Lap Belt Only Installation)—pg. 24, steps 4B-6B.



SECURING THE BASE (LAP AND SHOULDER BELT INSTALLATION)

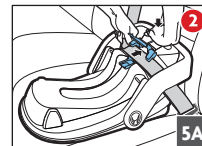
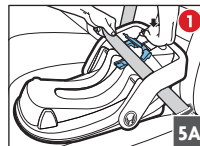
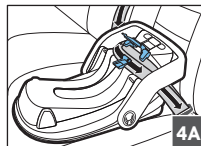

STEP 4A: Route the vehicle belt through the vehicle belt path while guiding the lap portion of the belt as close as possible to the top of the lock-off where the door hinges. Buckle the vehicle belt.

STEP 5A: Hold shoulder portion of belt above base. With one hand, push down base in the direction of the seat bight (crease of seat) and hold firm as you pull shoulder belt **1**. While holding taut, slide shoulder belt back through the belt path as close as possible to the top of the lock-off **2**.

NOTE: TIGHTNESS INDICATOR SHOULD BE GREEN.



STEP 6A: Close the top section of the lock-off over the lap/shoulder belt **1**. Second, close the bottom section of the lock-off over the belt **2**. Make sure you push the bottom of the lock-off all the way down until you hear an audible click.

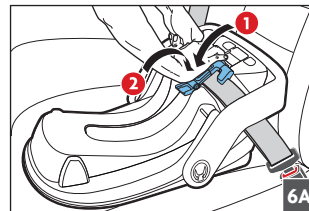

NOTE: Check that the base doesn't move more than 1 in side to side at the belt path. If movement is more than 1 in, twist the buckle and then fasten the seat belt to help secure fit.



SECURING THE BASE (LAP BELT ONLY INSTALLATION)

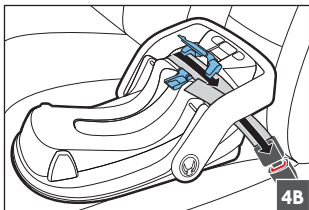

STEP 4B: Route the vehicle belt through the belt path while guiding the lap portion of the belt as close as possible to the top side of the lock-off where the door hinges. Buckle the vehicle belt.

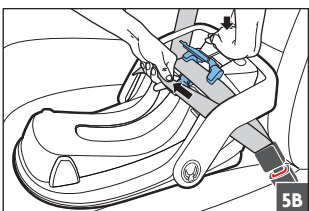

STEP 5B: With one hand push down base and hold firm as you pull lap belt to tighten and remove any slack.

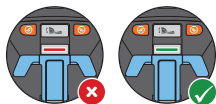

NOTE: TIGHTNESS INDICATOR SHOULD BE GREEN.

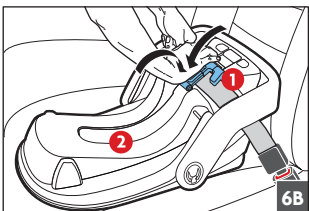

STEP 6B: Close the top section of the lock-off over the belt **1**. Second, close the bottom section of the lock-off over the belt **2**. Make sure you push the bottom of the lock-off all the way down until you hear an audible click.

NOTE: Before closing the lock-off door, make sure the vehicle seat belt has not slipped down into the belt path and is as close as possible to the top side of the lock-off where the door hinges.

NOTE: Check that the base doesn't move more than 1 in side to side at the belt path. If movement is more than 1 in, twist the buckle and then fasten the seat belt to help secure fit.



SAFETY CHECK

- **Lock-off must be used at all times when installing with a vehicle seat belt.**
- Base doesn't move more than 1 in side to side at the belt path **A**. If movement is more than 1 in, twist the *buckle* and then fasten the seat belt to help secure fit.
- Ensure tightness indicator is green after each use. If it is not, open lock-off then tighten belt. When tightness indicator turns green, close lock-off **B**.
- Belts are secure and untwisted
- Recline angle is correct. Base is level when only green is visible between the two arrows on the level indicator. No red should be visible **C**.

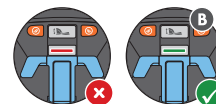
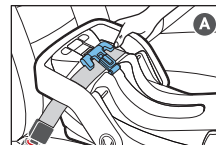

UNINSTALLING THE BASE

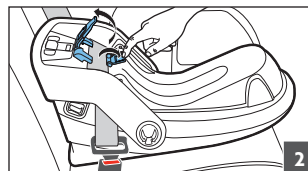

- STEP 1:** Unbuckle seat belt.
- STEP 2:** Open lock-off.
- STEP 3:** Remove seat belt.



LEVELING THE CARRIER

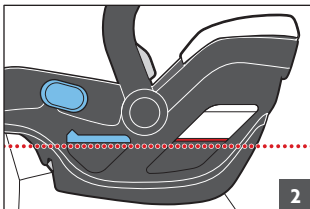
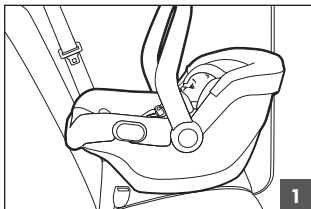

STEP 1: Place the carrier rear-facing on the vehicle seat.

STEP 2: Make sure the vehicle is parked on level ground and the red line on the carrier is level to the vehicle floor.

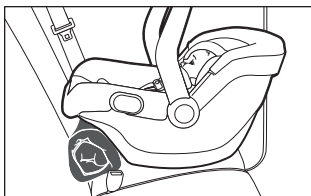

NOTE: For a more stable installation, a pool noodle or rolled towel may be used.



DETERMINING BEST INSTALLATION METHOD

If your vehicle does not have the LATCH System in your preferred seating position, the car seat must be secured to the vehicle using a vehicle seat belt. The car seat with the base or without the base can be secured using vehicle seat belts. There are two methods of carrier only installation:

LAP/SHOULDER STANDARD ROUTING METHOD: Installation with both the lap and shoulder belt. (proceed to pg. 27)

LAP ONLY METHOD: No shoulder belt is used. This method applies to vehicle with no shoulder belt and aircraft. (proceed to pg. 29)



LAP/SHOULDER BELT STANDARD ROUTING METHOD

STEP 1: Route the lap portion of the seat belt through both lap belt guides on the carrier, and buckle the seat belt.

STEP 2: Lock vehicle seat belt.

NOTE: See vehicle owner's instruction book for more information on locking your seat belt for child restraint installations.

⚠ WARNING!
Vehicle seat belt must lock; otherwise a locking clip must be used. See pg. 28 for instructions.

STEP 3: Push the carrier into the vehicle seat bight (crease of the seat) while pulling on the shoulder portion of the seat belt closest to the buckle.

NOTE: Check that the carrier is still properly leveled.

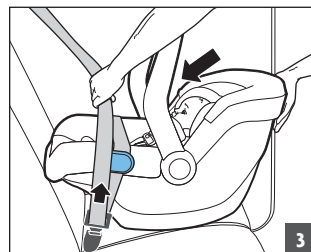
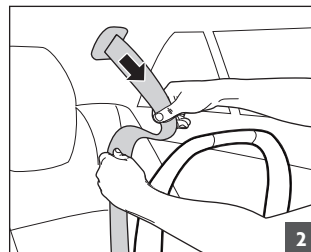
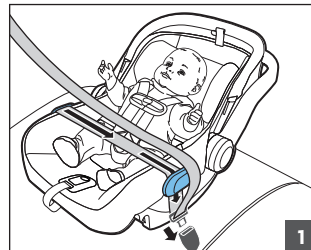



LAP/SHOULDER BELT STANDARD ROUTING METHOD

⚠ WARNING!

Vehicle seat belt must lock; otherwise a locking clip must be used. See instructions below.



INSTALLATION WITH LOCKING CLIP

NOTE: The locking clip can be found on the underside of the base (pg. 11). The locking clip can be used FOR CARRIER AND BASE installation with Lap/Shoulder belt combination when the seat belt does not lock.

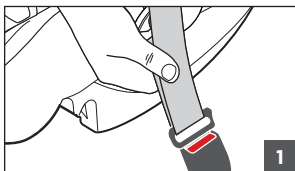

STEP 1: While pushing into the child restraint, pull the seat belt tight to eliminate any slack then pinch both pieces of seat belt webbing directly behind the latch plate. Unbuckle the belt without letting the webbing slip.

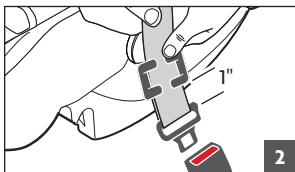

STEP 2: Thread the locking clip onto both lap and shoulder belts 1 in from the latch plate.

STEP 3: Re-buckle the vehicle belt.

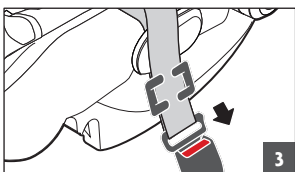

LAP BELT ONLY ROUTING METHOD

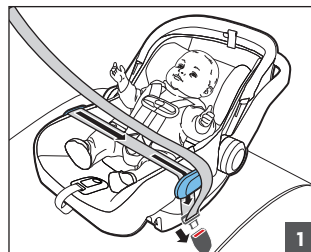

STEP 1: Route the lap belt through both guides on the carrier, and buckle the seat belt.

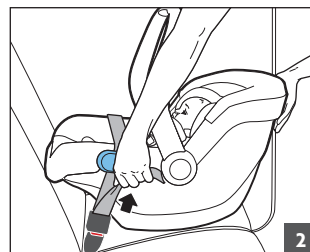

STEP 2: Push the carrier into the vehicle seat bight (crease of the seat) while pulling on the loose portion of the lap belt closest to the buckle.

NOTE: Check that the carrier is still properly leveled.



SAFETY CHECK

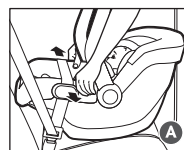

- Carrier doesn't move more than 1 in side to side at the belt path **A**.
- Belts are secure and untwisted.

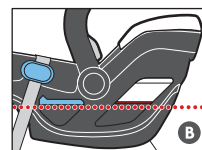

- Angle is correct when the vehicle is parked on level ground and the red line on the carrier is level to the vehicle floor **B**.

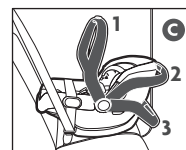

- Seating position is permitted by both UPPAbaby and your vehicle manufacturer for use with the type of Vehicle Seat Belt.
- Carry handle is locked in any of the three (3) positions **C**.

AIRCRAFT INSTALLATION

**THIS CHILD RESTRAINT IS CERTIFIED FOR AIRCRAFT USE.**

UPPAbaby and the Federal Aviation Administration (FAA) strongly recommend that children up to 40 lbs (18 kg) use a certified harnessed child restraint or other device approved for aircraft travel.

When installing this child restraint on an airplane, install the same way as [Carrier Installation with Vehicle Seat Belt/ Lap Belt Only Routing Method](#) (pg. 29).

IMPORTANT: Make sure that the aircraft buckle does not interfere with the belt guides on the infant carrier.

IMPORTANT NOTES:

- Notify the airline ahead of time that you'll be traveling with a child restraint.
- Install this carrier in a window seat to avoid blocking the aisle.
- Ask for a seat belt extender if the lap belt is too short.
- Use only on a forward-facing aircraft seat.
- DO NOT use this restraint if a secure installation cannot be achieved.
- Place carry handle in any of the (3) locked positions for use in the aircraft as long as it doesn't interfere with the back of the seat in front of the carrier.

⚠ WARNING!

- DO NOT use base with aircraft installation. Only the carrier is certified for aircraft use.
- Inflatable seat belts are NOT compatible with this child restraint.

HARNESSES BUCKLE POSITIONING

The crotch belt and buckle has two use positions. Always position the buckle and crotch strap in the slot closest to the child. If the child is on top of the buckle in the inner position, then adjust the buckle to the outer position.

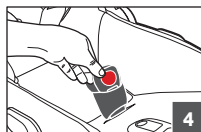
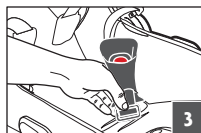
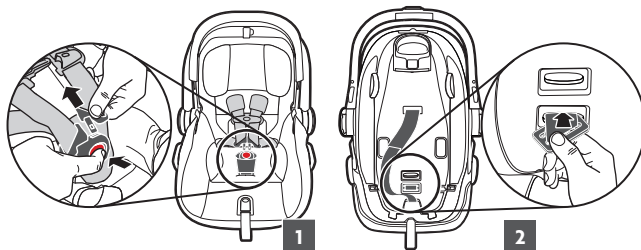

STEP 1: Unbuckle the harness.

STEP 2: Flip carrier over, insert the metal clip completely through the shell and seat pad.

STEP 3: Locate the appropriate buckle slot and insert from the top completely through the slot on the seat pad and shell.

STEP 4: Check that buckle is securely attached by pulling up on buckle.

INFANT INSERT (4-8 LBS)

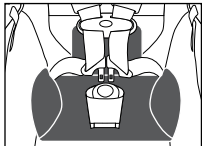

To ensure a better fit for smaller infants, we recommend using the infant insert (included) between 4 and 8 lbs. Remove infant insert when infant begins growing on top of the buckle making it difficult to buckle harness.

NOTE: *Never use non-regulated products with this child restraint, unless approved by UPPAbaby.*

SIP CARRIAGE + HARNESS POSITIONING

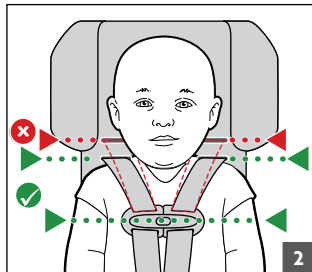
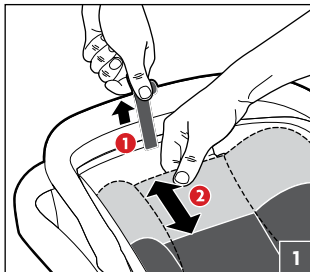

This child restraint has an adjustable head restraint and no-rethread harness system that is easy to adjust to properly secure the child.

STEP 1: Adjust the head restraint by pulling on the adjuster tab **1** and sliding the head restraint up or down **2**.

STEP 2: Position the head restraint so the harness rests at the child's shoulders or slightly below.

SECURING YOUR CHILD

STEP 1: Loosen the harness by pressing on the harness adjuster release button and pulling out the shoulder straps.

STEP 2: Open the retainer clip, unbuckle the harness, and tuck the latch plates into the side pockets to hold harness open.

STEP 3: Place infant in child restraint making sure their body is making full contact with the seating surface. Place harness over child and insert buckle tongues into the buckle until a "click" is heard. Pull up on the buckle tongues to make sure they are locked.

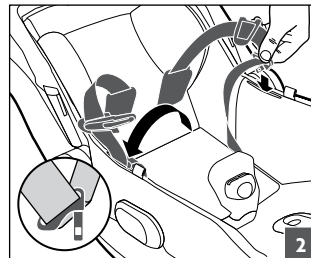
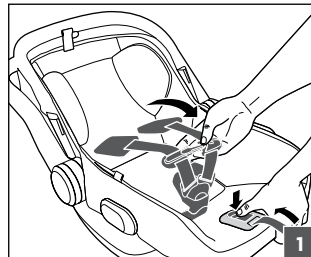

⚠️ WARNING!

- **DO NOT** place rolled towel or small blanket between crotch of infant and buckle or around head or SIP carriage.
- **NEVER** use non-regulated products with this child restraint, unless approved by UPPAbaby.

SECURING YOUR CHILD



4

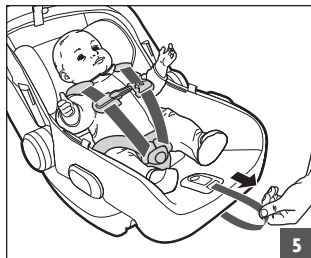

5

STEP 4: Pull up on the harness to remove excess slack around the child's legs.

STEP 5: Pull the harness adjuster strap to snugly adjust the harness straps around your child.

STEP 6: Close retainer clip and position at armpit level. Make sure the shoulder pads don't interfere with positioning the chest clip.

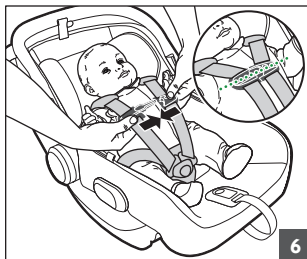

6

NOTE: For smaller babies, it is recommended to remove the harness pads for a more secure fit.

PINCH TEST

**HARNES SHOULD BE SNUG.**

Pinch harness webbing at child's shoulders. If you can pinch webbing, the harness is too loose and should be tightened.

ATTACHING CARRIER TO BASE

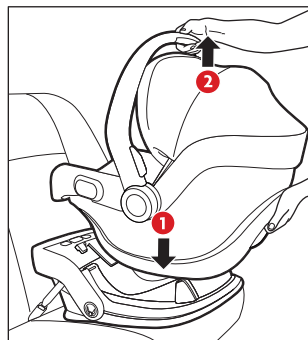

2

1

STEP 1: Place carrier on base until a click is heard **1**.

STEP 2: Check for a secure connection by pulling up on carry handle **2**.

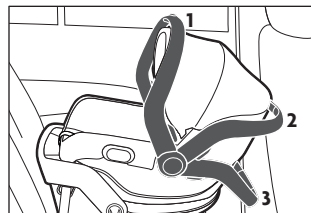

NOTE: Handle can be in any of the three (3) locked positions for use in the vehicle.

RELEASING CARRIER FROM BASE



1

STEP 1: Pull and hold carrier release button on back of the carrier.

STEP 2: Lift carrier off base.

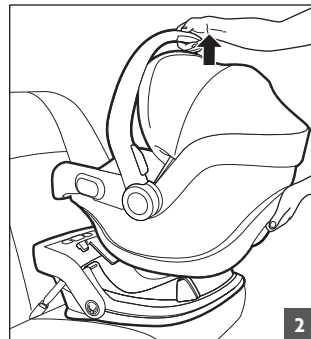

2

HIDE-AWAY CANOPY

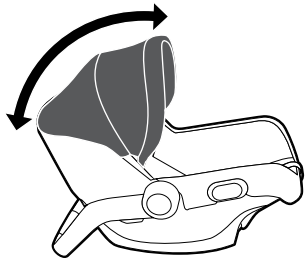

Hide-away canopy easily adjusts to one of three (3) positions.

TO EXTEND CANOPY: Slowly pull forward on main canopy frame until resting in desired position.

TO RETRACT/STOW CANOPY: Gently push downward on main canopy frame allowing the center support and canopy fabric to guide into the storage compartment in carrier.

CARRY HANDLE

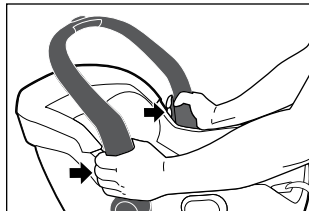
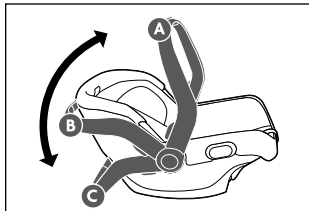

The carry handle must be locked in any three (3) positions when in use:

A carry, **B** store and **C** stand.

To adjust the carry handle position, squeeze both handle adjustment buttons and rotate forward or backward.

⚠️ WARNING!

NEVER use non-regulated products with this child restraint, unless approved by UPPAbaby.

IMPORTANT CHECKS

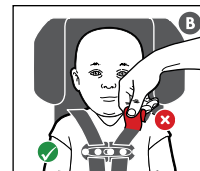
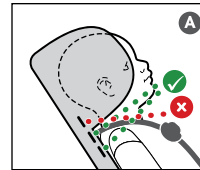

- This child restraint is for rear-facing use only.
- The seat must be tightly installed in a forward-facing vehicle seat.
- The harness should be at the shoulders or slightly below **A**.
- Retainer clip must be at armpit level and harness straps should be snug **B**.
- The top of child's head should not be less than 1 in from the top of the headrest when in its highest position.
- The child must weigh between 4 and 35 pounds and be no taller than 32 in.
- The back seat is the safest place for children aged 12 and under.
- NEVER use non-regulated products with this child restraint, unless approved by UPPAbaby.
- NEVER place in front of an active airbag.
- Install using lower anchor or the vehicle seat belt, NOT BOTH.
- DO NOT secure an infant in the carrier with extra material, bulky clothing, or extra padding. Instead place a blanket over the harness after properly securing the child **C**.
- Carry handle must be locked in any of the (3) handle positions.

- Adjust base to the appropriate angle by using the angle indicator on the sides of the base or the level to ground line on the carrier.
- Always check the tightness indicator is green after each use.
- Always secure an unoccupied child restraint; in a crash an unsecured infant car seat may injure occupants in your vehicle.

FITTING CARRIER TO STROLLER FRAME

Prior to fitting MESA carrier to stroller frame, engage brake on stroller and remove toddler seat from frame.

STEP 1: With carrier facing stroller handle, align carrier handle hubs with attachment posts on stroller.

STEP 2: Let carrier slide onto attachment posts. An audible click indicates proper attachment.

STEP 3: Lift up on car seat handle to check attachment.

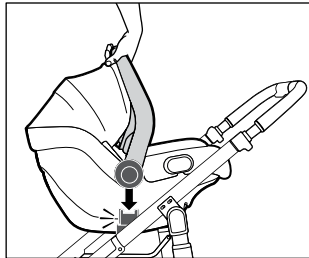

NOTE: Compatible with VISTA 2015+ and CRUZ strollers.

RELEASING CARRIER FROM STROLLER FRAME

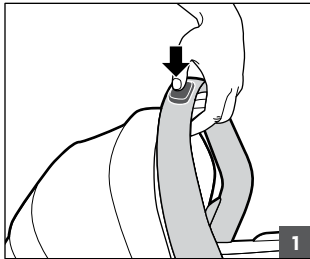

STEP 1: Engage and hold the stroller release button on the top of the carry handle.

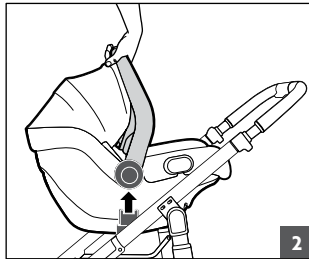

STEP 2: Lift the carrier off stroller frame.

FITTING ADAPTERS TO VISTA 2014 AND EARLIER FRAME

Prior to fitting adapter to VISTA 2014 and earlier frame, engage brake on stroller and remove toddler seat or bassinet from frame.

NOTE: VISTA 2014 and earlier stroller models require adapters for use with the MESA. Please visit: uppababy.com/mesa/spare-parts to purchase your adapter.

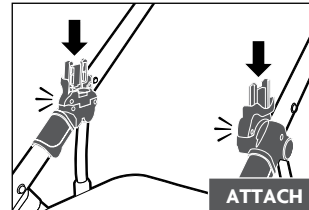

ATTACH

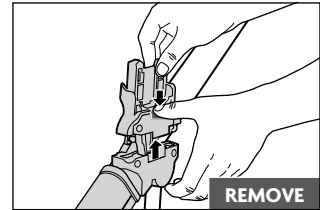

REMOVE

TO ATTACH: Place adapters (logo facing out) onto seat attachments and press until you hear a click.

TO REMOVE: Push down release button on backside of adapter and lift up from stroller frame.

NOTE: There are 2 adapters, one for the left and one for the right side of the stroller. The adapters are marked with "L" and "R" respectively. (The left adapter and left side of the stroller are determined by the driver's left.)

NOTE: Indicators should appear green as confirmation of secure installation. If the indicator symbol is red then the adapter is not secure. Remove the adapter and try fastening it again.

FITTING CARRIER TO VISTA 2014 AND EARLIER FRAME ADAPTERS

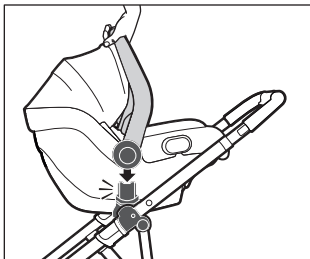

STEP 1: With carrier facing stroller handle, align carrier stroller hubs with adapters on stroller.

STEP 2: Let carrier slide onto adapter posts.

STEP 3: Lift up on carrier handle to check attachment.

RELEASING CARRIER FROM VISTA 2014 AND EARLIER FRAME ADAPTERS

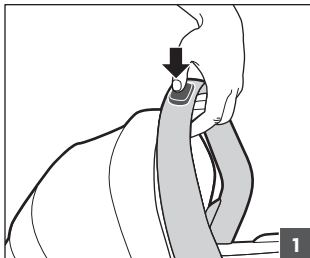

STEP 1: Engage and hold the stroller release button on the top of the carry handle.

STEP 2: Lift the carrier off the adapters on stroller frame.

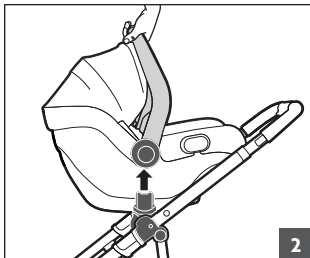

SIP PADDING REMOVAL

Following are fabric removal instructions for cleaning.

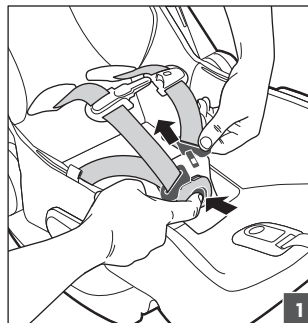

STEP 1: Unbuckle retainer clip and harness.

STEP 2: Pull forward on SIP padding releasing harness straps.

STEP 3: Pull SIP padding down from bottom and release.

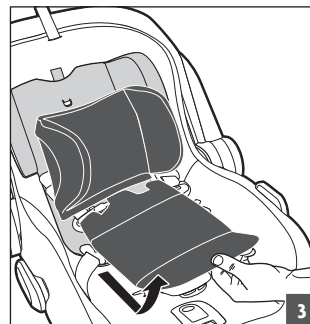
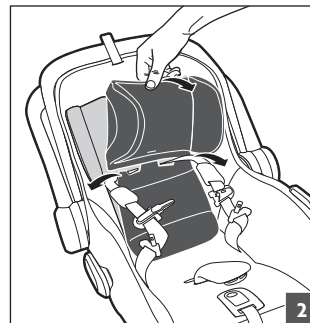

SEAT PADDING REMOVAL

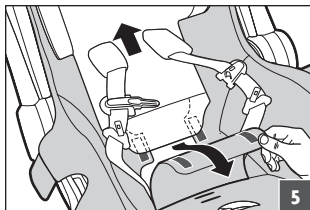
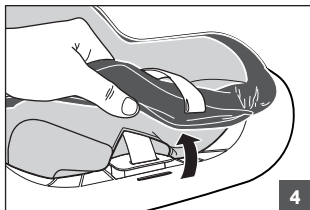
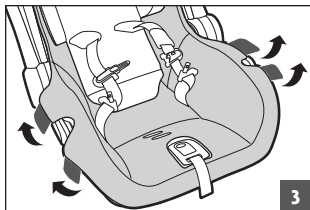
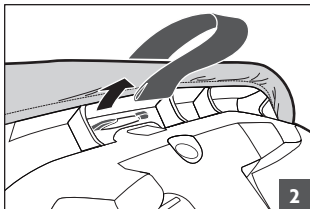
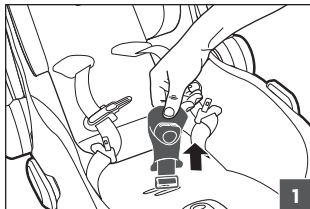

STEP 1: Remove buckle cover.

STEP 2: Unhook harness adjuster strap from underside of carrier.

STEP 3: Remove (4) plastic tabs from front sides of carrier.

STEP 4: Loosen padding from front end of carrier and free padding from around harness adjuster release button housing.

STEP 5: Raise SIP to highest position and pull back padding panel.

SEAT PADDING REMOVAL

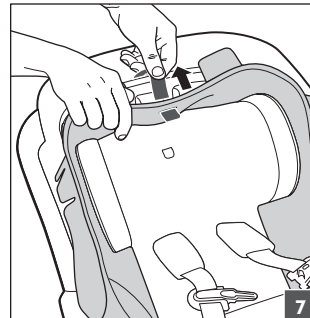
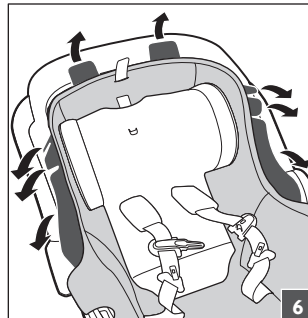

STEP 6: Slide SIP to lowest position and release (8) plastic tabs from upper portion of carrier.

STEP 7: Thread SIP adjuster tab through buttonhole in top of seat pad.

STEP 8: Pull seat padding up and forward to remove padding around SIP.

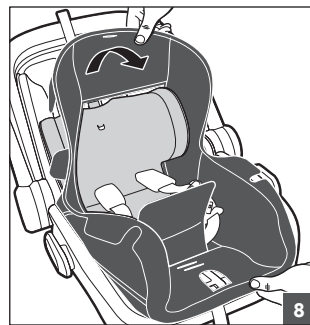

SEAT PADDING INSTALLATION

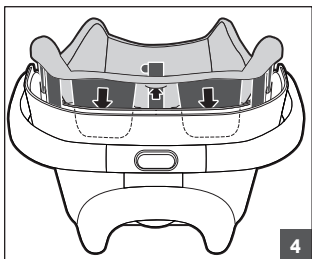
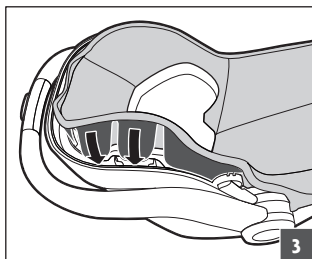
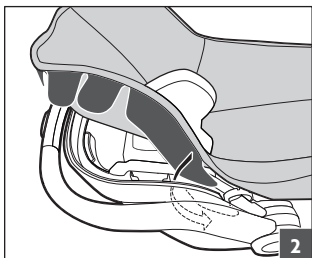
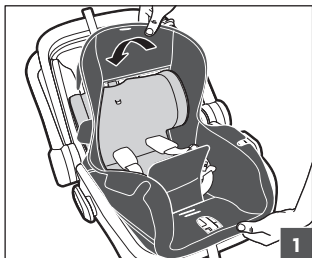

STEP 1: With the SIP in the lowest position, lay seat pad over carrier, open Velcro® flap and fit opening around SIP/headrest.

STEP 2: Tuck lowest side tab behind seat foam and under post. Repeat on other side.

STEP 3: Place second side tab into designated plastic slot and third side tab behind seat foam. Repeat on other side.

STEP 4: Tuck top 2 tabs into designated slots and pull headrest adjuster tab through buttonhole

SEAT PADDING INSTALLATION

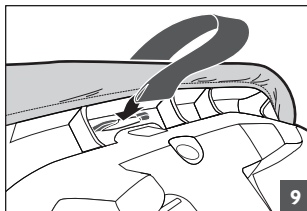
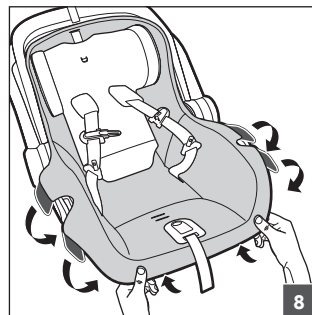
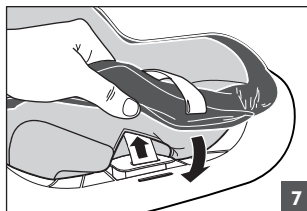
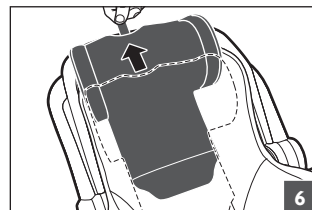
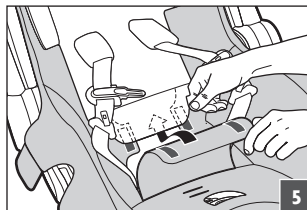

STEP 5: Lift lower part of SIP and pull harness straps to each side of opening. Secure padding panel with Velcro®.

STEP 6: Raise SIP/headrest into highest position.

STEP 7: Pull harness adjuster strap through opening in seat pad and install pad around adjuster release button housing.

STEP 8: Wrap padding around front lip and install 4 lower plastic tabs.

STEP 9: Reconnect harness adjuster strap.

SIP PADDING INSTALLATION

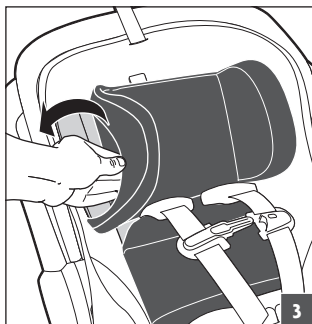
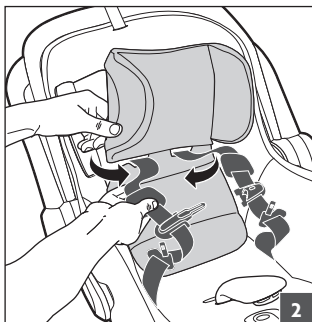
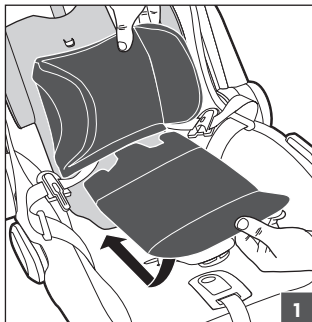

STEP 1: Insert lower part of SIP carriage into pocket on the back of SIP padding.

STEP 2: Guide harness straps back into slots in SIP padding.

STEP 3: Secure SIP cover tightly around SIP ears.

CLEANING

CLEANING FABRICS

Fabrics include: seat pad, infant inserts, buckle pads and shoulder pad.



Machine wash in cold water on gentle cycle with mild detergent.



Dry flat and away from direct sunlight before re-use or storage.



DO NOT bleach, iron or dry clean.

CLEANING HARNESS WEBBING + CANOPY



Spot clean using warm water with mild detergent.



Air dry completely before re-use or storage.



DO NOT bleach or iron.

CLEANING PLASTIC



Spot clean using warm water with mild detergent.



Towel dry completely before re-use or storage.



DO NOT bleach.

CLEANING BUCKLE AND LOWER ANCHOR CONNECTOR HARDWARE

NOTE: Buckle should fasten with a “click” if not, rinse under warm running water. **DO NOT** use detergents or lubricants.

LIMITED WARRANTY



Welcome to the UPPAbaby family! We are with you for the long haul. Register your car seat within three months to claim your Limited Lifetime Warranty*.

Register your product at: uppababy.com/register

*Lifetime warranty applies to UPPAbaby car seats and only the original owner, within the lifetime of the product. To receive your Limited Lifetime Warranty, you must register your car seat within three months of purchase and provide a valid purchase receipt from an authorized UPPAbaby retailer. The "lifetime" of the product is defined as the period of use by the registrant for use with his/her children up to 7 years from date of manufacture.

Your UPPAbaby product is warranted to be free from any manufacturing defects for a period of 2 years from the date of purchase under normal use and in compliance with the operating instructions.

This warranty is not transferable and extends only to the original retail purchaser and is only valid when supplied with proof of purchase. Please retain proof of purchase for this limited warranty.

The warranty is valid only in the original country of purchase. This warranty is subject to the conditions set forth by country in which the items were purchased. Conditions may vary. UPPAbaby will not ship replacement or repair parts out of the country of purchase. UPPAbaby will provide replacement parts or conduct repairs as determined fitting by the company. UPPAbaby reserves the right to exchange item with a replacement part. Some parts may be replaced with newer model parts as the product is improved over time.

Please note that a repair issue will NOT be covered by this warranty if:

- The issue is caused by misuse or poor maintenance. Please refer to this instruction book for guidance on car seat use and maintenance.
- Damage is caused by improper installation of UPPAbaby parts and/or accessories. Please refer to this instruction booklet for guidance on car seat assembly and use.
- Damage is corrosion caused by lack of maintenance or service.
- Damage is due to general wear and tear, which is the result of everyday use or negligence.
- Damage is caused by sun intensity, sweat, detergents, damp storage or frequent washings.
- Repairs or modifications are carried out by a third party.
- Product is purchased from an unauthorized retailer. Approved retailers are listed on our website at uppababy.com.
- Product is second-hand.
- Product is damaged as a result of an accident, airline or freight damage.

UPPAbaby reserves the right to determine if warranty terms and conditions have been met.

Please contact your local distributor if you have any questions regarding warranty.